

# JACKSON TWP. S $\frac{1}{2}$

T.30N.

R.15E.

ALLAN D. FRISINGER, R.L.S.

ALLEN COUNTY SURVEYOR

REVISED JUNE 1980 PER AUG. 1971 JEG  
SUB AREAS REVISED 1-83  
REVISED OCT. 1973  
REVISED OCT. 1991

MARCH 1955  
REVISED JAN. 1970  
REVISED JANUARY 1970  
DRAINS CR. 24.71' 24.00'

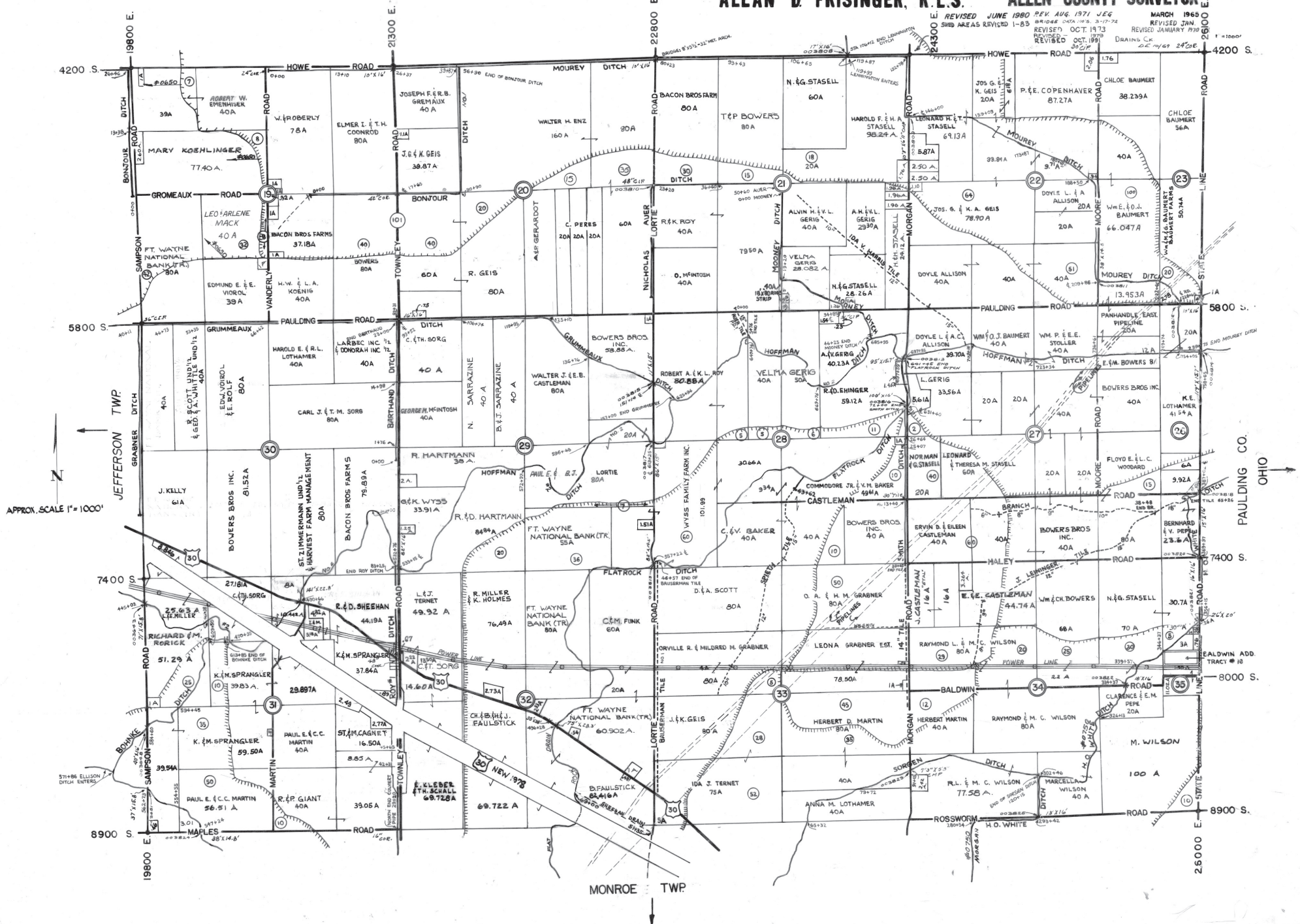

APPROX. SCALE 1" = 1000'

JEFFERSON TWP.

MONROE TWP.

PAULDING CO. OHIO