

WAYNE TWP. N 1/2

T. 30 N. R. 12 E.

ALLAN D. FRISINGER, R.L.S.

ALLEN COUNTY SURVEYOR

REVISED MAY 1968 T.M.
APR 1970
SEPT 1971
OCT 1980
JAN. 1984

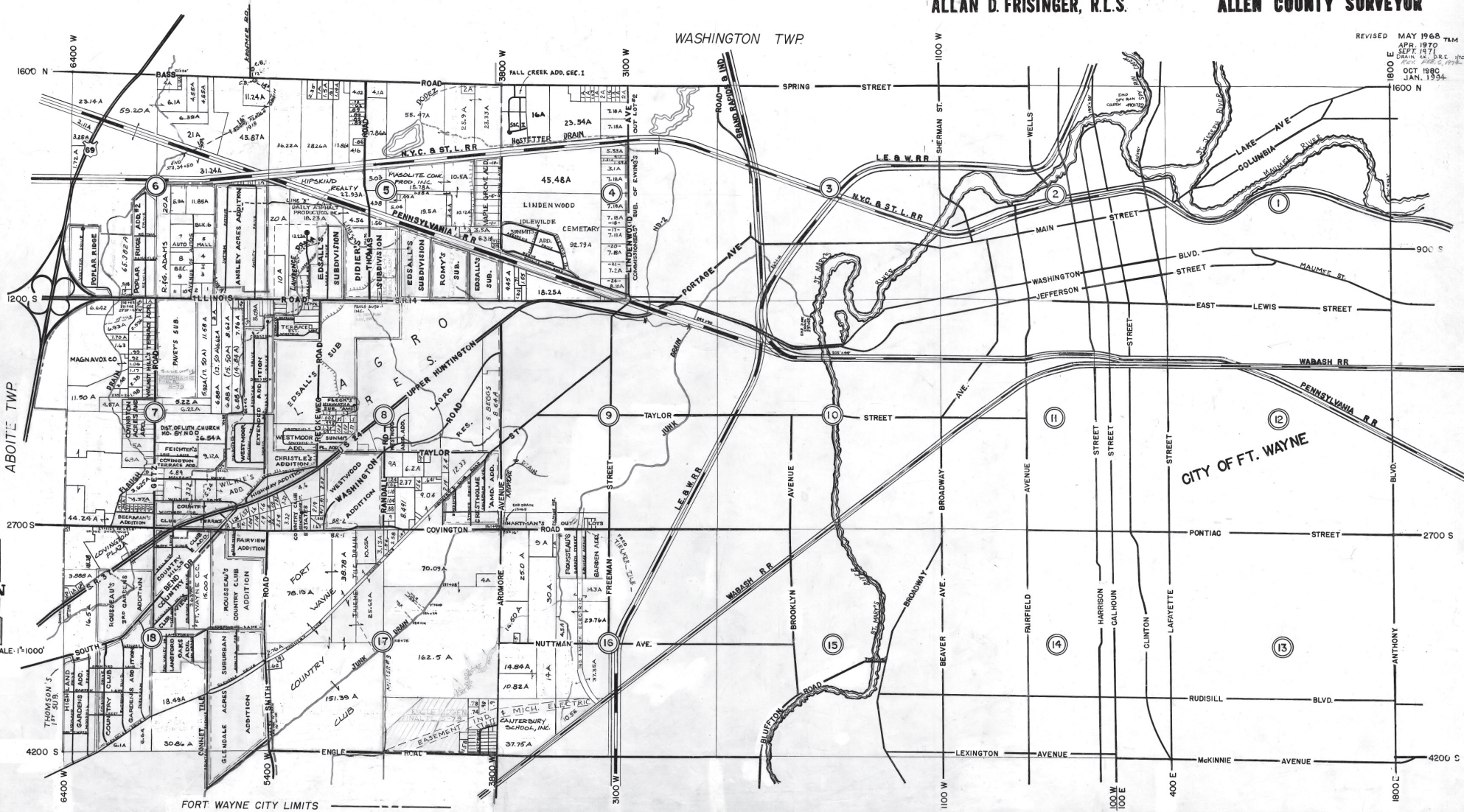

APPROX. SCALE: 1"=1000'

N

FORT WAYNE CITY LIMITS

CITY OF FT. WAYNE

ADAMS TWP.

ABOITE TWP.

WASHINGTON TWP.